

Shorter, Momentary Action, LED Illuminated Pushbutton

The LP3S series of momentary action, LED illuminated pushbutton switches offer most of the same features as the LP3 series, but are about 5/8" shorter behind panel.

High contact pressure and extremely low contact bounce are the result of the OTTO snap-action mechanism. Extra long electrical life and precise trip point offer added value and precision operation.

On sealed models, a silicone boot protects the contact area against contamination. This boot provides long life and smooth operation over a wide temperature range. Sealed terminals protect the contact area from hostile environments and solder flux on both sealed and unsealed models.

Standard LED illumination color choices include red, green, amber, blue, deep green and white. This precision snap-action switch is designed for use in grips and other applications with limited space in off-highway, material handling, industrial controls, marine, medical and demanding commercial industries.

LP3S Key Features:

- Shorter version of OTTO's LP3 series
- Watertight to IP68S and IP69K, moistureproof & dusttight to IP64, or unsealed
- LED lighted with the ability to accommodate 2, 12 & 24VDC power & includes reverse voltage protection
- Tall & dome style buttons permitting printed legends
- Logic level option
- Quick disconnect terminals
- 5/8" thread, press fit & dome case options
- RoHS compliant



LP3S-3 Front Mount

LP3S-F Flush Dome

Standard Characteristics/Ratings:			
ELECTRICAL RATINGS:			
Load	Sea Level @ 28VDC		
Resistive	5A		
Inductive	3A		
Lamp	1A		
Motor	3A		
DWV	1000Vrms through switch contacts only		
Logic Level	10mA @ 5VDC		
Electrical Life:	25,000 cycles		
LIGHTING:			
Light Source Voltage (DC)	Actual Voltage	Nominal (DC)	Voltage Max (DC)
2	2		2.5
12	12		14
24	24		28.6
Mechanical Life:	250,000 cycles		
Seal:	Unsealed, IP64 or IP68S and IP69K		
Operating Temp Range:	-55°C to +85°C		
Operating Force:	2.5 +/- 0.5 lb. or 4.0 +/- 1.0 lb.		
Total Travel:	0.080 inches +/- 0.015		
Overtravel:	0.010 inches min		
MATERIALS:			
Case:	Anodized aluminum alloy		
Button:	Thermoplastic		
Center Cap:	Anodized aluminum alloy		
Mounting Hardware:	Hex nut, lockwasher and panel seal gasket (watertight only)		

LP3S-EXXXXXX
Exposed Flush Dome Button

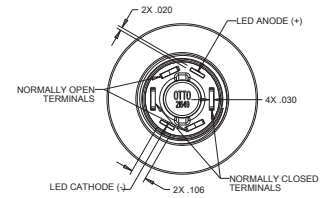
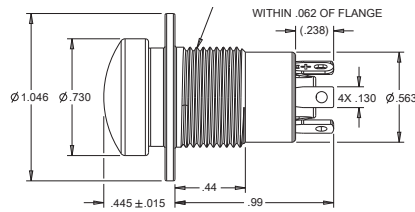
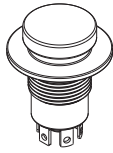

LP3S-FXXXXXX
Flush Dome Button

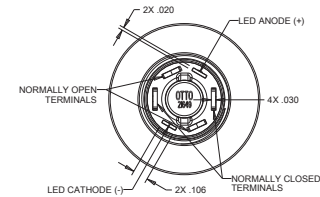
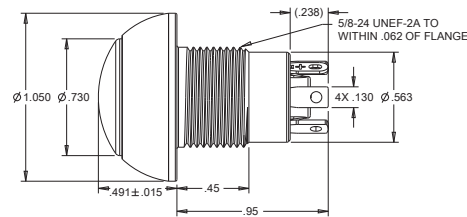
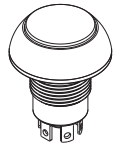

LP3S-RXXXXXX
Raised Dome Button

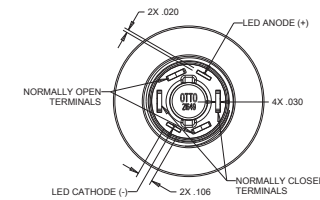
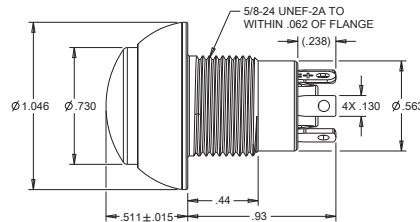
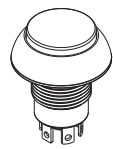

LP3S-1XXXXXX
Press Fit Mount

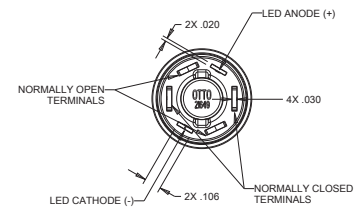
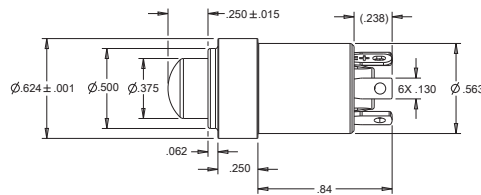
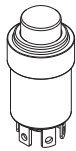

LP3S-3XXXXXX
Front Mount

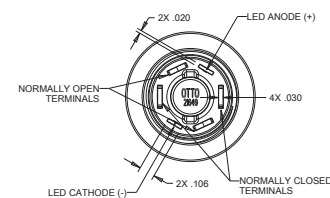
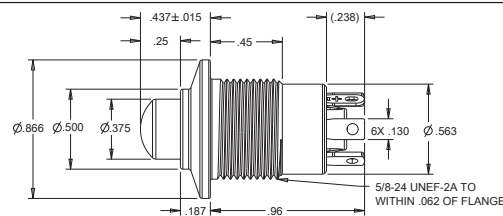
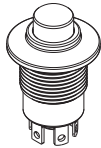

LP3S-6XXXXXX
Rear Mount

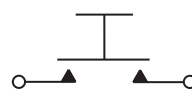
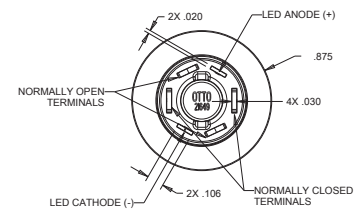
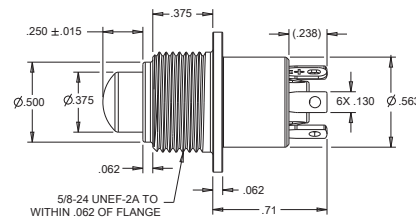
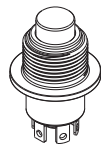

SPST-NO-DB
SCHEMATIC

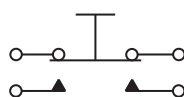

SPDT-DB
SCHEMATIC

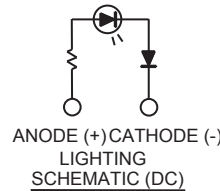

ANODE (+) CATHODE (-)
LIGHTING
SCHEMATIC (DC)