

NOTES:

- CHANGE OF MATERIAL IS NOT PERMITTED UNLESS APPROVED IN WRITING BY OTTO ENGINEERING PERSONNEL.
- DRAWING TO BE INTERPRETED IN ACCORDANCE WITH THE CURRENT REVISION OF ASME Y14.5M.
- TSI TO BE INTERPRETED AS THEORETICAL SHARP INTERSECTION.
- THIS PART/PRODUCT IS TO BE MANUFACTURED WITH THE APPLICABLE REGULATIONS OF EC DIRECTIVES 2002/95/EC AND 2002/96/EC, RESTRICTION OF THE USE OF HAZARDOUS SUBSTANCES IN ELECTRICAL AND ELECTRONIC EQUIPMENT (RoHS) AND WASTE ELECTRICAL AND ELECTRONIC EQUIPMENT (WEEE).
- PARTS SHALL BE PACKAGED IN A MANNER TO PREVENT SCRATCHING, BOWING OR OTHER DAMAGE DURING SHIPMENT.
- PART MAY HAVE ANGLED CUTS DUE TO THICKNESS OF THE MATERIAL.

PART NUMBER	THICKNESS
807039-1	.062±.010
807039-2	.031±.005

807039

REV	OCN #	DATE	APR
A	982039	13 MAY 98	JBC
B	983364	13 AUG 98	JBC
C	983654	08 SEP 98	JBC
D	028917	22 SEP 05	TP

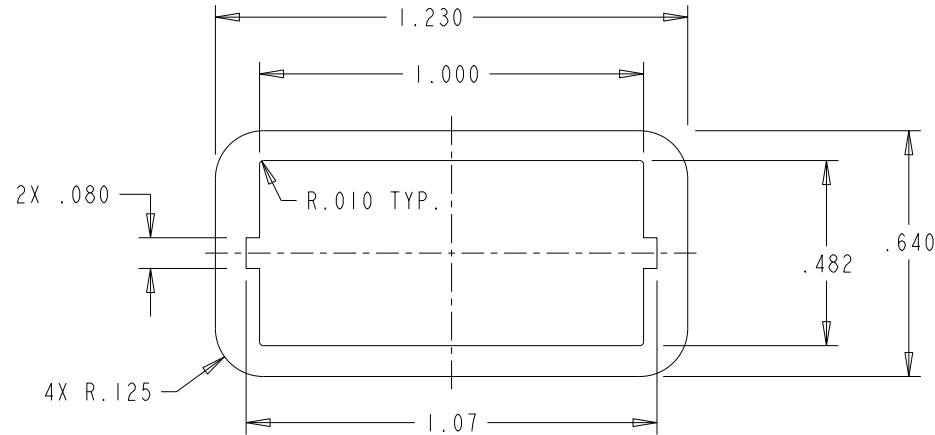

MANUFACTURING

SPC

PROCESS:

MATERIAL:
EPDM RUBBER
30-40 DUROMETER
COLOR: BLACK

OTTO CONTROLS
DIVISION OF
OTTO ENGINEERING INC.
CARPENTERSVILLE, ILLINOIS USA

DESCRIPTION

KI, GASKET, EPDM

(D)

UNLESS OTHERWISE SPECIFIED:
DIMENSIONS ARE IN INCHES.
TOLERANCES ARE AS LISTED.
MUST BE FREE FROM BURRS
AND SHARP EDGES.

TOLERANCES
.XX ±.01
.XXX ±.005
ANGLES ±1°
SURFACES 64 MICROINCH
DO NOT SCALE DRAWING.

THIS DOCUMENT IS THE CONFIDENTIAL
PROPERTY OF OTTO ENGINEERING, INC..
IT IS NOT TO BE USED IN ANY WAY
DETRIMENTAL TO THE INTERESTS
OF OTTO ENGINEERING, INC..

DRWN. K LW

SIZE

FSCM NO

DRAWING NO.

REV.

CHKD. K LW

A

21649

807039

D

WT.

THIRD ANGLE
PROJECTION



Scale 2:1

Sheet 1 OF 1