

B6-11101

| LET | OCN    | DATE      | APR |
|-----|--------|-----------|-----|
| A   | 961040 | 14 MAR 96 | LK  |
| B   | 962022 | 20 MAY 96 |     |

**CHARACTERISTICS**

**ELECTRICAL:**

ELECTRICAL LIFE AT AMBIENT TEMPERATURE:  
 50,000 CYCLES AT 28 VDC, 10 AMPS RESISTIVE  
 25,000 CYCLES AT 28 VDC, 10 AMPS INDUCTIVE  
 DWV: 1500 VRMS  
 CONTACT RESISTANCE: .025 MAX. OHMS INITIAL  
 L/R: .026

**MECHANICAL:**

MECHANICAL LIFE: 1,000,000 CYCLES  
 PRETRAVEL: .030±.010  
 OPERATE FORCE: 7 ozs. TO 20 ozs.  
 RESET FORCE: 3 oz. MIN.  
 MOVEMENT DIFFERENTIAL: .015 MAX.

**PHYSICAL:**

TEMPERATURE RANGE: -55°C TO +85°C  
 SHOCK: CONDITION I, METHOD 213, 100 G's  
 CASE MATERIAL: DIAYLL PHTHALATE  
 COVER MATERIAL: THERMOPLASTIC POLYESTER  
 BUTTON MATERIAL: THERMOPLASTIC POLYESTER  
 TERMINAL MATERIAL: ELECTROLYTIC TOUGH-PITCH  
 COPPER ALLOY 110  
 PER QQ-C-576  
 CONTACT: .000050 MIN. GOLD PLATE  
 PER MIL-G-45204 TYPE II  
 GRADE C, OVER SILVER

MARKING: OTTO, 21649  
 B6-11101  
 DATE CODE  
 TERMINAL IDENT.

(B)

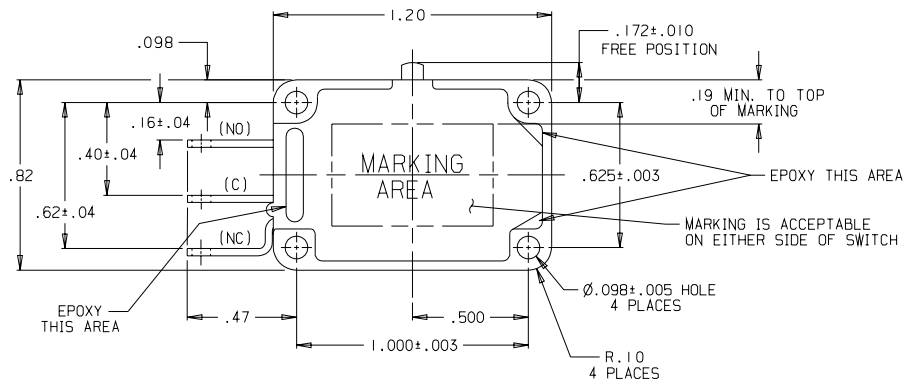
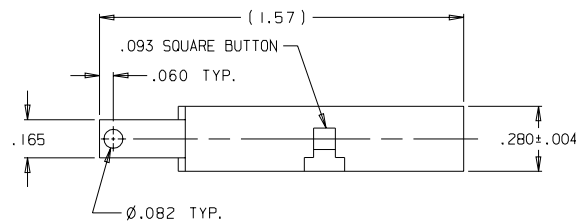

- MINOR
- MAJOR
- CRITICAL
- SPC CRITICAL

UNLESS OTHERWISE SPECIFIED:  
 DIMENSIONS ARE IN INCHES.  
 TOLERANCES:  
 .XX ±.03  
 .XXX ±.010  
 ANGLES ±2°  
 DO NOT SCALE

THIRD ANGLE PROJECTION

OTTO CONTROLS  
 DIVISION OF  
 OTTO ENGINEERING INC.  
 CARPENTERSVILLE, ILLINOIS USA

THIS DOCUMENT IS THE CONFIDENTIAL PROPERTY OF OTTO ENGINEERING, INC.. IT IS PROVIDED ON A RESTRICTED BASIS AND IS NOT TO BE USED IN ANY WAY DETRIMENTAL TO THE INTERESTS OF OTTO ENGINEERING, INC..

PART NAME  
 SWITCH - BASIC SPDT

| DRWN. | JHK       | SIZE | FSCM NO      | DRAWING NO. | REV.   |
|-------|-----------|------|--------------|-------------|--------|
| CHKD. | LK        | B    | 21649        | B6-11101    | B      |
| APPD. | RG        |      |              |             |        |
| DATE  | 14 MAR 96 | WT.  | 9 GRAMS MAX. | SCALE       | 2:1    |
|       |           |      |              | SHEET       | 1 OF 1 |