

B6-21101

LET	OCN	DATE	APR
A	972103	16 MAY 97	RG

CHARACTERISTICS

ELECTRICAL:

ELECTRICAL LIFE AT AMBIENT TEMPERATURE:
 50,000 CYCLES AT 28 VDC, 10 AMPS RESISTIVE
 25,000 CYCLES AT 28 VDC, 10 AMPS INDUCTIVE
 DWV: 1500 VRMS
 CONTACT RESISTANCE: .025 MAX. OHMS INITIAL
 L/R: .026

MECHANICAL:

MECHANICAL LIFE: 1,000,000 CYCLES
 PRETRAVEL: .030±.010
 OPERATE FORCE: 7 ozs. TO 20 ozs.
 RESET FORCE: 3 ozs. MIN.
 MOVEMENT DIFFERENTIAL: .015 MAX.

PHYSICAL:

TEMPERATURE RANGE: -55°C TO +85°C
 SHOCK: CONDITION I, METHOD 213, 100 G's
 CASE MATERIAL: DIAYLL PHTHALATE
 COVER MATERIAL: THERMOPLASTIC POLYESTER
 BUTTON MATERIAL: THERMOPLASTIC POLYESTER
 TERMINAL MATERIAL: ELECTROLYTIC TOUGH-PITCH
 COPPER ALLOY 110
 PER QQ-C-576
 CONTACT: .000050 MIN. GOLD PLATE
 PER MIL-G-45204 TYPE II
 GRADE C, OVER SILVER

MARKING: OTTO, 21649
 B6-21101
 DATE CODE
 TERMINAL IDENT.

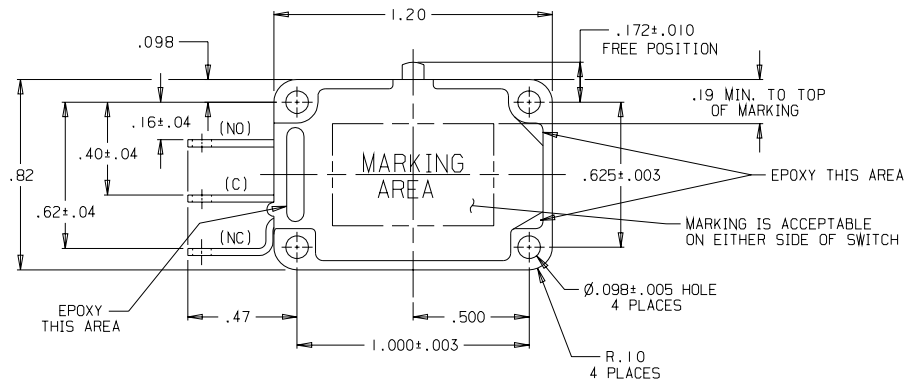
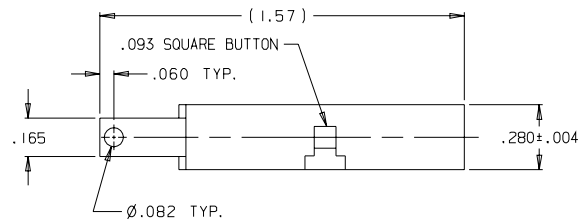

- MINOR
- MAJOR
- CRITICAL
- SPC CRITICAL

UNLESS OTHERWISE SPECIFIED:
 DIMENSIONS ARE IN INCHES.
 TOLERANCES:
 .XX ±.03
 .XXX ±.010
 ANGLES ±2°
 DO NOT SCALE

THIRD ANGLE PROJECTION

OTTO CONTROLS
 DIVISION OF
 OTTO ENGINEERING INC.
 CARPENTERSVILLE, ILLINOIS USA

THIS DOCUMENT IS THE CONFIDENTIAL PROPERTY OF OTTO ENGINEERING, INC.. IT IS PROVIDED ON A RESTRICTED BASIS AND IS NOT TO BE USED IN ANY WAY DETRIMENTAL TO THE INTERESTS OF OTTO ENGINEERING, INC..

PART NAME
 SWITCH - BASIC SPDT

DRWN.	JHK	SIZE	FSCM NO	DRAWING NO.	REV.
CHKD.	LK	B	21649	B6-21101	A
APPD.	RG				
DATE	14 MAR 96	WT.	9 GRAMS MAX.	SCALE	2:1
					SHEET 1 OF 1